

Angle, Allen

From: Douglas Wood <doug.wood@wipro.com>
Sent: Friday, July 1, 2022 1:55 PM
To: Angle, Allen
Subject: [EXTERNAL] Re: Equipment Assets, 3D and Location Aware

Follow Up Flag: Flag for follow up
Flag Status: Flagged

Caution: Message from external sender

Not there isn't. Please open an enhancement request.

Doug Wood
Wipro Limited

From: Angle, Allen <Allen.Angle@am.jll.com>
Sent: Thursday, June 30, 2022 5:42 PM
To: Douglas Wood <doug.wood@wipro.com>
Cc: Josh Meurer <jmeurer@us.ibm.com>
Subject: Equipment Assets, 3D and Location Aware

CAUTION:This email is received from an external domain. Open the hyperlink(s) & attachment(s) with caution.

As a follow-up on assets from my 2D email, I have also been asked in demos and I still don't have an answer, what about 3D

As it relates to the 2D but in 3D, is there not a way to go from clicking on an asset in this list to the 3D asset that is the model in the viewer?

Building Equipment

Building Equipment



<input type="checkbox"/>	!	Asset Name	Asset ID	Specification Name
		<input type="text" value="Contains"/>	<input type="text" value="Contains"/>	<input type="text" value="Contains"/>
<input type="checkbox"/>		AHU-R01	EQ-1000403	12.5 Tons
<input type="checkbox"/>		CU3-1001	EQ-1000401	Condensing Unit - Air Cooled - DX - 12.
<input type="checkbox"/>		CU3-1002	EQ-1000402	Condensing Unit - Air Cooled - DX - 12.
<input type="checkbox"/>		VAV-101	EQ-1000413	Condensing Unit - Air Cooled - DX - 12.
<input type="checkbox"/>		VAV-102	EQ-1000404	Condensing Unit - Air Cooled - DX - 12.
<input type="checkbox"/>		VAV-103	EQ-1000406	Condensing Unit - Air Cooled - DX - 12.
<input type="checkbox"/>		VAV-104	EQ-1000414	Condensing Unit - Air Cooled - DX - 12.
<input type="checkbox"/>		VAV-105	EQ-1000415	Condensing Unit - Air Cooled - DX - 12.
<input type="checkbox"/>		VAV-106	EQ-1000416	Condensing Unit - Air Cooled - DX - 12.
<input type="checkbox"/>		VAV-107	EQ-1000417	Condensing Unit - Air Cooled - DX - 12.
<input type="checkbox"/>		VAV-108	EQ-1000405	Condensing Unit - Air Cooled - DX - 12.
<input type="checkbox"/>		VAV-109	EQ-1000407	Condensing Unit - Air Cooled - DX - 12.
<input type="checkbox"/>		VAV-110	EQ-1000408	Condensing Unit - Air Cooled - DX - 12.
<input type="checkbox"/>		VAV-111	EQ-1000409	Condensing Unit - Air Cooled - DX - 12.
<input type="checkbox"/>		VAV-112	EQ-1000410	Condensing Unit - Air Cooled - DX - 12.
<input type="checkbox"/>		VAV-113	EQ-1000411	Condensing Unit - Air Cooled - DX - 12.
<input type="checkbox"/>		VAV-114	EQ-1000412	Condensing Unit - Air Cooled - DX - 12.

Items per page: 50

1 - 17 of 17 items

...and then the reverse, how do I go from the model and this linked asset to its asset data in TRIRIGA? I think the answer is you don't cause the viewer is segregated from the actual TRIRIGA asset data.



Tools / Administration /

BIM Model Management

Buckets

Model Files

Buildings

Viewer

Models

Object Key



1303_Law MEP.rvt

1303_Law ARCH.nwc

1303_Law ARCH.nwd

1303_Law ARCH.rvt

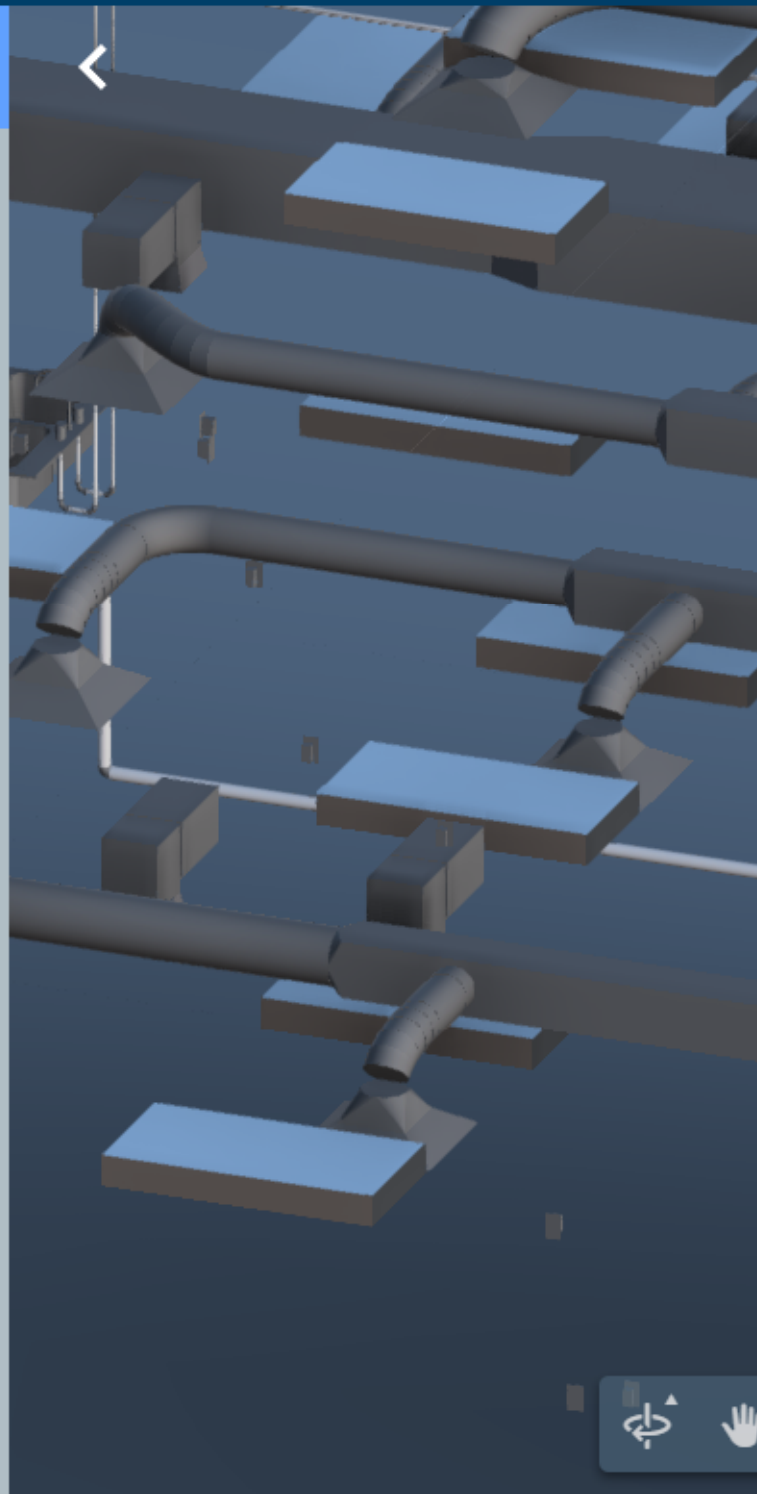

Even though I think we should be able to publish from Revit with linked files or have some process like that work, I do want to question the Navisworks upload as well.

I question why the TRIRGA BIM Help Guide talks about NWC files (left) vs. NWD files (right)? At least NWD files have the asset data that allows me to look up names so I can go back to the Assets in TRIRGIA and connect the dots between assets since I cannot find a process that links between them.

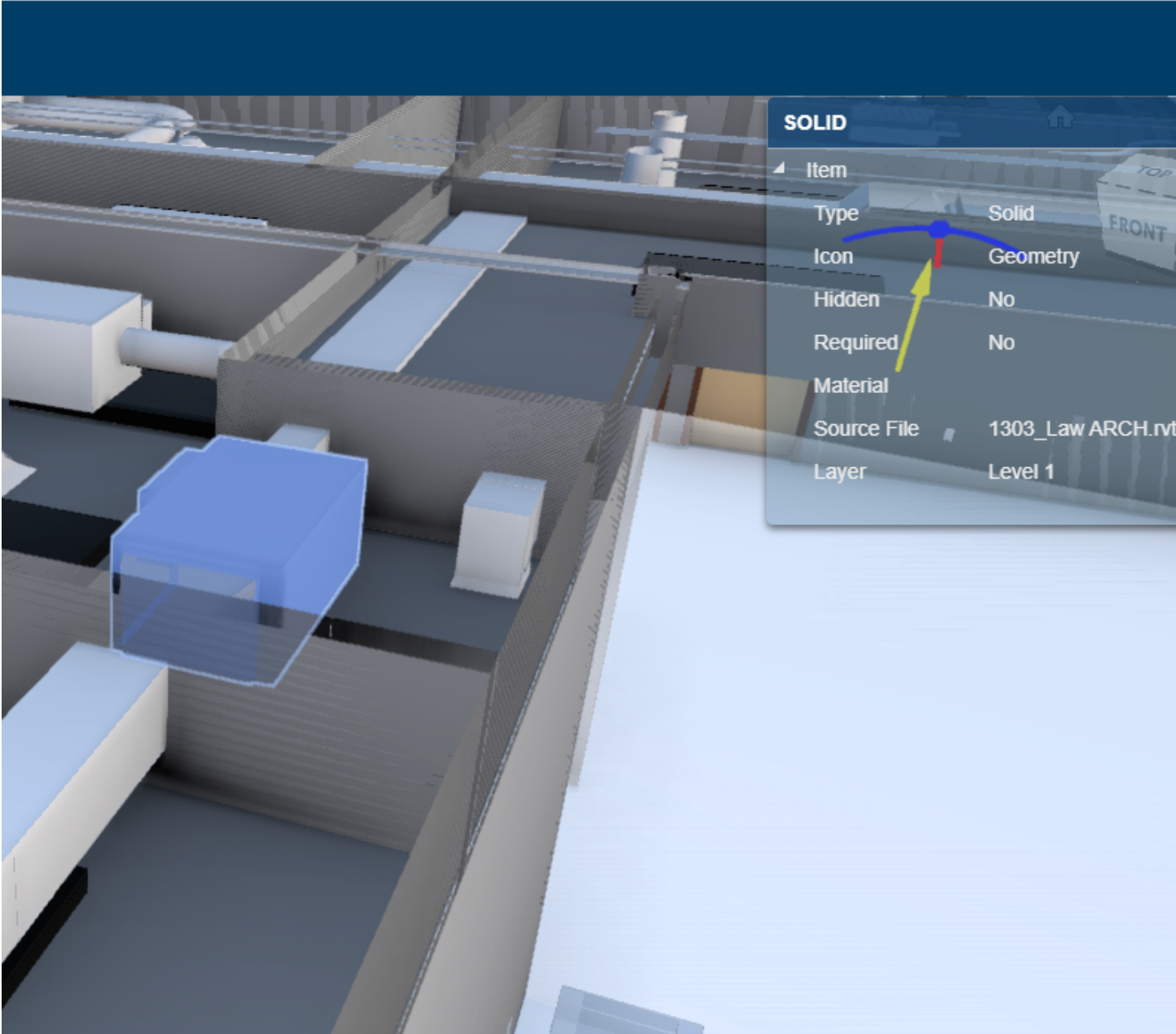

VAV UNIT - FAN POWERED - SERIES FLX

IBM.Description	8
IBM.BarCode	VAV-111
IBM.Name	VAV-111
Type Id	FamilySymbol "8", #357060
Primary Air Flow	900 CFM
Level	Level "Level 1", #368
Elevation from Level	8.500000000000002'
Family and Type	FamilySymbol "8", #357060
Outlet Air Flow	720 CFM
Area	18.185064196300477' ²
Primary Air Inlet Diameter	8"
System Classification	Supply Air, Return Air, Supply Air, Power
Mark	VAV-111
IBM.IsTRIRIGA	Yes
Asset Code	1303-HVAC-VAV-111
Volume	10.251676005055847 ft ³
Critical Path	No
System Name	Mechanical Supply Air 1, VAV-6

Thanks,

Allen Angle

VDC-FM Integration Manager

JLL Technologies

tel +1 980 224 2135

mobile +1 704 953 4379

www.us.jll.com



[One of the 2022 World's Most Ethical Companies®](#)

Jones Lang LaSalle

For more information about how JLL processes your personal data, please click [here](#)

This email is for the use of the intended recipient(s) only. If you have received this email in error, please notify the sender immediately and then delete it. If you are not the intended recipient, you must not keep, use, disclose, copy or distribute this email without the author's prior permission. We have taken precautions to minimize the risk of transmitting software viruses, but we advise you to carry out your own virus checks on any attachment to this message. We cannot accept liability for any loss or damage caused by software viruses. The information contained in this communication may be confidential and may be subject to the attorney-client privilege. If you are the intended recipient and you do not wish to receive similar electronic messages from us in the future then please respond to the sender to this effect.

'The information contained in this electronic message and any attachments to this message are intended for the exclusive use of the addressee(s) and may contain proprietary, confidential or privileged information. If you are not the intended recipient, you should not disseminate, distribute or copy this e-mail. Please notify the sender immediately and destroy all copies of this message and any attachments. WARNING: Computer viruses can be transmitted via email. The recipient should check this email and any attachments for the presence of viruses. The company accepts no liability for any damage caused by any virus transmitted by this email. www.wipro.com'

Internal to Wipro